

**RUSH
WITT &
WILSON**



**112 Stonehouse Drive, St Leonards-On-Sea, TN38 9DN
£199,950 Freehold**

Nestled in the charming area of St Leonards-On-Sea, this mid-terrace home on Stonehouse Drive presents a fantastic opportunity for those looking to create their dream residence. Spanning an impressive 949 square feet, the property boasts three well-proportioned bedrooms, making it ideal for families or those seeking extra space. The home features a welcoming reception room, perfect for entertaining guests or enjoying quiet evenings in. The property includes a bathroom, which, while in need of renovation, offers the chance to design a personal sanctuary tailored to your tastes. One of the standout features of this property is the garage en bloc, providing convenient off-street parking and additional storage options. The home is chain-free, allowing for a smoother transition for potential buyers. While the property requires full renovation, this presents a unique opportunity to reimagine the space and add value. With a little vision and effort, this house can be transformed into a stunning family home in a desirable location. St Leonards-On-Sea is known for its picturesque surroundings and vibrant community, making this property an excellent choice for those looking to settle in a welcoming neighbourhood. Don't miss the chance to make this house your own and enjoy all that this lovely area has to offer.





RUSH
WITT &
WILSON



RUSH
WITT &
WILSON



RUSH
WITT &
WILSON



RUSH
WITT &
WILSON





Floor 0 Building 1

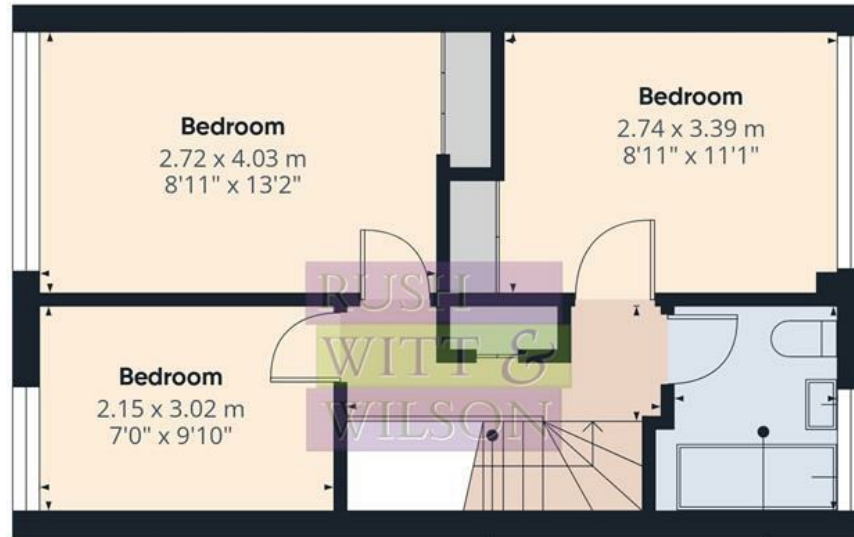

Floor 1 Building 1



Floor 0 Building 2



Approximate total area⁽¹⁾

88.3 m²

949 ft²

(1) Excluding balconies and terraces

Calculations reference the RICS IPMS 3C standard. Measurements are approximate and not to scale. This floor plan is intended for illustration only.

GIRAFFE360

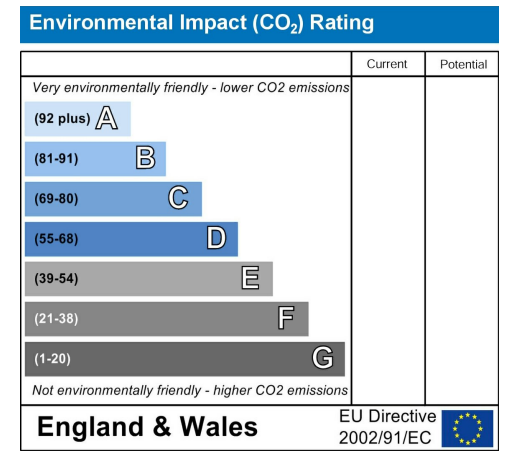
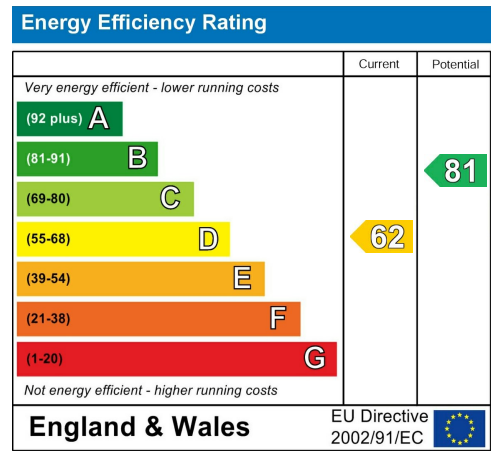
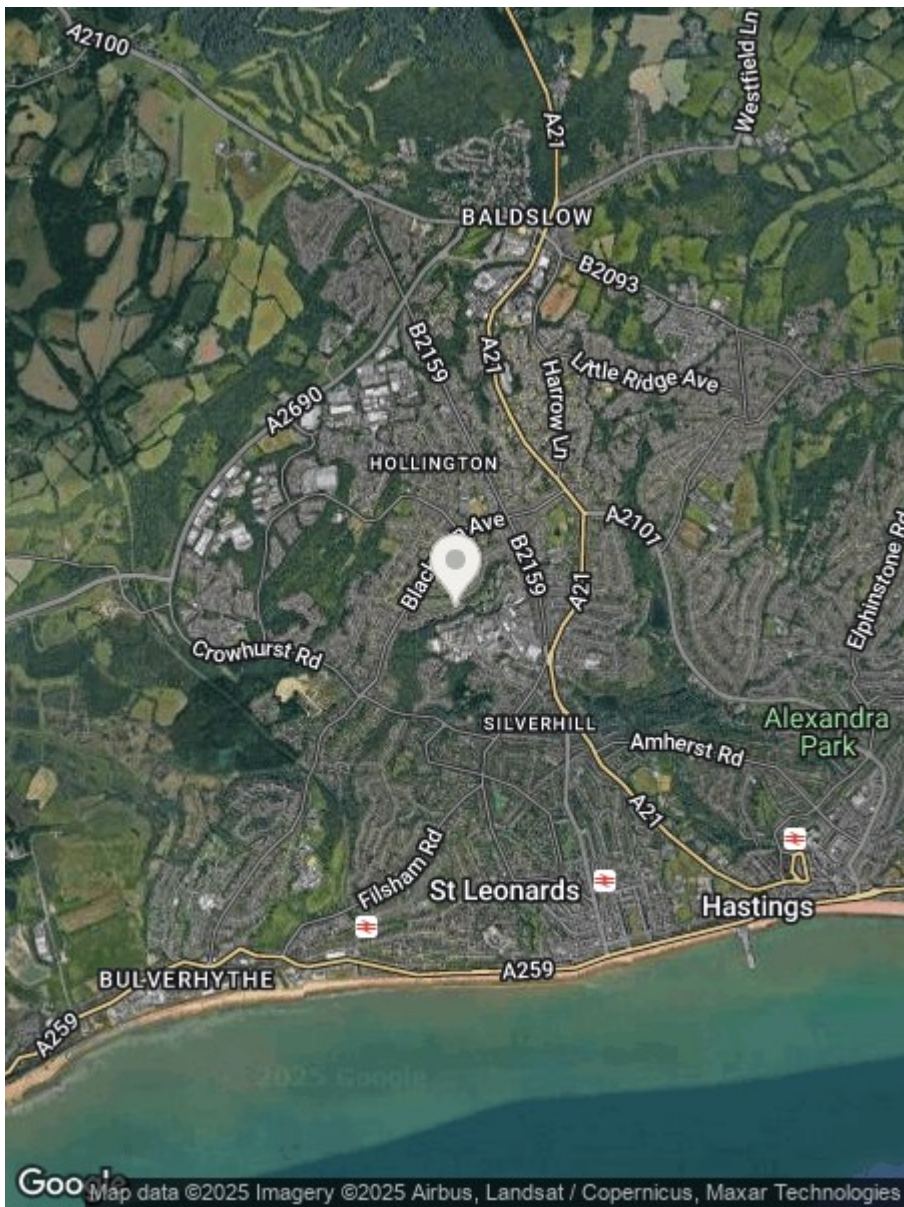

**RUSH
WITT &
WILSON**

**Residential Estate Agents
Lettings & Property Management**



**Rother House Havelock Road
Hastings
East Sussex
TN34 1BP
Tel: 01424 442443
hastings@rushwittwilson.co.uk
www.rushwittwilson.co.uk**